

The steel fittings are made of tubular steel to DIN 2441 and boast good resistance to mechanical stresses. Hot dip galvanised steel fittings are completely coated with a layer of pure zinc and are therefore protected against rust.

They are used in pipe construction, plumbing and gas installations as well as a wide range of industrial applications, especially in conjunction with the popular malleable iron series.

Material: Zinc plated steel ST 37-2 and steel with a bare metal surface ST 37-2
 Working pressure: Max. 50 bar
 Surface: Hot dip galvanised steel and steel with a bare metal surface
 Standard thread: acc. to ISO 7-1

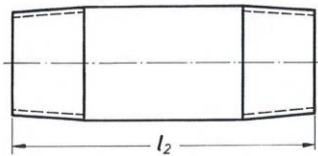

SFR 23-1280

Pipe double nipple 23, ET/ET, galvanised steel ST 37-2

Art. No.	Type No.	Thread	l_2 mm
113209	SFR 23-1440	R 1/4	40.0
113210	SFR 23-1460	R 1/4	60.0
113211	SFR 23-1480	R 1/4	80.0
113212	SFR 23-14100	R 1/4	100.0
113213	SFR 23-14120	R 1/4	120.0
113214	SFR 23-14150	R 1/4	150.0
113215	SFR 23-14180	R 1/4	180.0
113216	SFR 23-14200	R 1/4	200.0
113217	SFR 23-3840	R 3/8	40.0
113218	SFR 23-3860	R 3/8	60.0
113219	SFR 23-3880	R 3/8	80.0
113220	SFR 23-38100	R 3/8	100.0
113221	SFR 23-38120	R 3/8	120.0
113222	SFR 23-38150	R 3/8	150.0
113223	SFR 23-38180	R 3/8	180.0
113224	SFR 23-38200	R 3/8	200.0

Pipe double nipple 23, ET/ET, galvanised steel ST 37-2

Art. No.	Type No.	Thread	l ₂ mm
113225	SFR 23-1240	R 1/2	40.0
113226	SFR 23-1260	R 1/2	60.0
113227	SFR 23-1280	R 1/2	80.0
113228	SFR 23-12100	R 1/2	100.0
113229	SFR 23-12120	R 1/2	120.0
113230	SFR 23-12150	R 1/2	150.0
113231	SFR 23-12180	R 1/2	180.0
113232	SFR 23-12200	R 1/2	200.0
113233	SFR 23-3440	R 3/4	40.0
113234	SFR 23-3460	R 3/4	60.0
113235	SFR 23-3480	R 3/4	80.0
113236	SFR 23-34100	R 3/4	100.0
113237	SFR 23-34120	R 3/4	120.0
113238	SFR 23-34150	R 3/4	150.0
113239	SFR 23-34180	R 3/4	180.0
113240	SFR 23-34200	R 3/4	200.0
113241	SFR 23-1040	R 1	40.0
113242	SFR 23-1060	R 1	60.0
113243	SFR 23-1080	R 1	80.0
113244	SFR 23-10100	R 1	100.0
113245	SFR 23-10120	R 1	120.0
113246	SFR 23-10150	R 1	150.0
113247	SFR 23-10180	R 1	180.0
113248	SFR 23-10200	R 1	200.0
113249	SFR 23-11440	R 1 1/4	40.0
113250	SFR 23-11460	R 1 1/4	60.0
113251	SFR 23-11480	R 1 1/4	80.0
113252	SFR 23-114100	R 1 1/4	100.0
113253	SFR 23-114120	R 1 1/4	120.0
113254	SFR 23-114150	R 1 1/4	150.0
113255	SFR 23-114180	R 1 1/4	180.0
113256	SFR 23-114200	R 1 1/4	200.0
113257	SFR 23-11240	R 1 1/2	40.0
113258	SFR 23-11260	R 1 1/2	60.0
113259	SFR 23-11280	R 1 1/2	80.0
113260	SFR 23-112100	R 1 1/2	100.0
113261	SFR 23-112120	R 1 1/2	120.0
113262	SFR 23-112150	R 1 1/2	150.0
113263	SFR 23-112180	R 1 1/2	180.0
113264	SFR 23-112200	R 1 1/2	200.0
113265	SFR 23-2040	R 2	40.0
113266	SFR 23-2060	R 2	60.0
113267	SFR 23-2080	R 2	80.0
113268	SFR 23-20100	R 2	100.0
113269	SFR 23-20120	R 2	120.0
113270	SFR 23-20150	R 2	150.0
113271	SFR 23-20180	R 2	180.0
113272	SFR 23-20200	R 2	200.0

Pipe double nipple 23, ET/ET, galvanised steel ST 37-2

Art. No.	Type No.	Thread	l ₂ mm
113273	SFR 23-21280	R 2 1/2	80.0
113274	SFR 23-212100	R 2 1/2	100.0
113275	SFR 23-212120	R 2 1/2	120.0
113276	SFR 23-212150	R 2 1/2	150.0
113277	SFR 23-212180	R 2 1/2	180.0
113278	SFR 23-212200	R 2 1/2	200.0
113279	SFR 23-3080	R 3	80.0
113280	SFR 23-30100	R 3	100.0
113281	SFR 23-30120	R 3	120.0
113282	SFR 23-30150	R 3	150.0
113283	SFR 23-30180	R 3	180.0
113284	SFR 23-30200	R 3	200.0

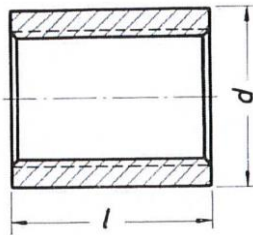

SFM 16-1234

Weld-on coupler 16, IT/IT, steel with a bare metal surface ST 37-2, continuous thread

Art. No.	Type No.	Thread	d mm	l mm
113285	SFM 16-1425	Rp 1/4	17.5	25.0
113286	SFM 16-3826	Rp 3/8	21.3	26.0
113287	SFM 16-1234	Rp 1/2	26.4	34.0
113288	SFM 16-3436	Rp 3/4	31.8	36.0
113289	SFM 16-1043	Rp 1	39.5	43.0
113290	SFM 16-11448	Rp 1 1/4	48.3	48.0
113291	SFM 16-11248	Rp 1 1/2	54.5	48.0
113292	SFM 16-2056	Rp 2	66.3	56.0
113293	SFM 16-21265	Rp 2 1/2	82.0	65.0
113294	SFM 16-3071	Rp 3	95.5	71.0

The dimensions are approximate values in mm.